

# RELIABILITY™

## Provin

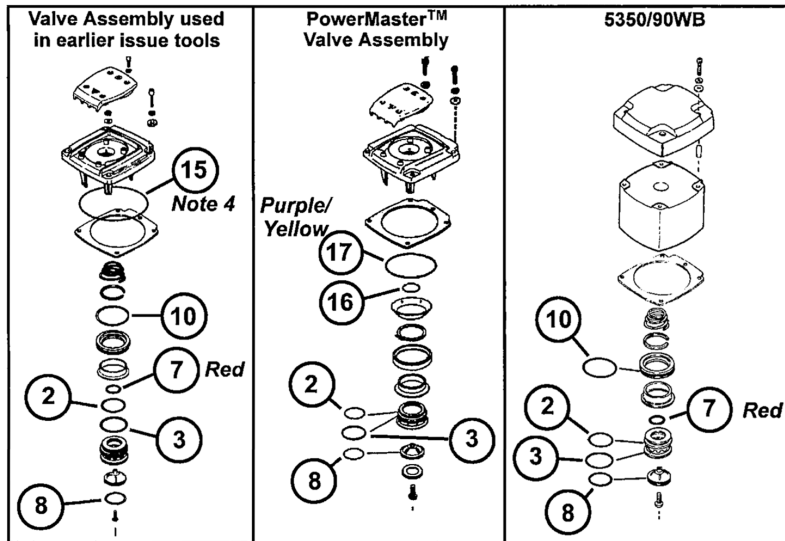

### Contents of O-Ring Kit KT-PA-530

Key Number	Quantity	Performance Provin, Inc.		Equivalent Paslode® Part Number
		Part Number	Color Code	
1	1	OR-PP-150		92174
2	1	OR-PP-188		91208
3	1	OR-PP-190		401950
4	1	OR-PP-192		91024
5	1	OR-PP-342		402031
6	2	OR-PP-354		91541
7	1	OR-PP-376	Red	401951
8	1	OR-PP-382		95432
9	1	OR-PP-412		92762
10	1	OR-PP-414		401952
11	1	OR-PP-432		401985
12	1	OR-PP-568		91591
13	1	OR-PP-576	Red	92971
	1	OR-PP-869	White	Note 2
14	1	OR-PP-578		Note 5
15	1	OR-PP-584		Note 4
16	1	OR-PP-372		Note 6
17	1	OR-PP-2087	Purple / Yellow	Note 6

13 White (Oversize)  
13 Red (Std.)  
See Note 2

5250/65C  
5250/65S-PP  
5300/75C  
5350/75S  
5350/75PLUS  
5350/80S  
5350/90C

5350/90WB

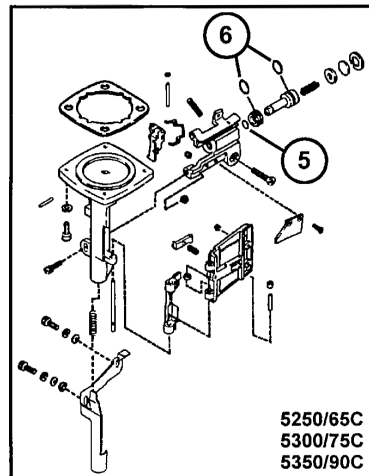

5250/65C  
5300/75C  
5350/90C

**Note 2:** O-Ring OR-PP-869 ( color code white ) is provided for use in situations where the piston and/or cylinder sleeve is worn and the standard O-Ring ( OR-PP-576 ) will not seal properly. Not applicable for 5350/90 WB use.

**Note 3:** Not used on strip Nailers.

**Note 4:** Not used on earlier issue tools or 5350/ WB.

**Note 5:** Only used on 5350/90 WB.

**Note 6:** Only used on PM assemblies.

\*Generously grease all O-rings at time of assembly

Note: Read and understand the safety information printed on the reverse side before repairing any tools.  
Nota: Lea y comprende la información de seguridad impresa al reverso antes de reparar cualquier herramienta.

10/9/2006

Exploded View and O-ring List for  
PASLODE 5200/5300 SERIES TOOLS

VL-PA-24

**CAUTION****CAUTION****CAUTION**

ALWAYS WEAR SAFETY GLASSES WITH SIDE SHIELDS WHEN USING PNEUMATICALLY OPERATED FASTENER DRIVING TOOLS

NEVER POINT THE TOOL AT YOURSELF OR ANYONE ELSE

NEVER BYPASS OR REMOVE ANY SAFETY DEVICE

ALWAYS FOLLOW THE ORIGINAL MANUFACTURE'S SAFETY AND SERVICE INSTRUCTION

NEVER ATTEMPT TO SERVICE OR REPAIR A PNEUMATICALLY OPERATED TOOL WITH THE COMPRESSED AIR LINE CONNECTED TO THE TOOL

NEVER LEAVE A PNEUMATICALLY OPERATED TOOL UNATTENDED WITH THE COMPRESSED AIR LINE CONNECTED

ALWAYS FOLLOW THE ORIGINAL TOOLS MANUFACTURE'S DISASSEMBLY, ASSEMBLY, AND TOOL INSPECTION PROCEDURES

**PRECAUTION****PRECAUTION****PRECAUTION**

SIEMPRE USE LENTES DE SEGURIDAD CON PROTECTORES LATERALES AL USAR HERRAMIENTAS DE IMPULSO CON SUJETADOR DE OPERACIÓN NEUMÁTICA

NUNCA APUNTE A SI MISMO O A OTRA PERSONA CON LA HERRAMIENTA

NUNCA EVITE O RETIRE ALGÚN DISPOSITIVO DE SEGURIDAD

SIEMPRE SIGA LAS INSTRUCCIONES DE SEGURIDAD Y SERVICIO DEL FABRICANTE ORIGINAL DE LA HERRAMIENTA

NUNCA INTENTE HACER MANTENIMIENTO O REPARAR UNA HERRAMIENTA DE OPERACIÓN NEUMÁTICA CON LA LINEA DE AIRE COMPRIMIDO CONECTADA A LA HERRAMIENTA

NUNCA DEJE SIN ATENCIÓN UNA HERRAMIENTA DE OPERACIÓN NEUMÁTICA CON LA LINEA DE AIRE COMPRIMIDO CONECTADA

SIEMPRE SIGA LOS PROCEDIMIENTOS DE DESMONTAJE, MONTAJE, E INSPECCIÓN DEL FABRICANTE ORIGINAL DE LA HERRAMIENTA

## O-Ring Kit

# KT-PA-530

For use on the following tool models.  
Kit contains all O-Rings in these tools.

PASLODE	5250/65C
	5250/65S-PP
	5300/65-CF
	5300/75-CF
	5300/75C
	5300/75C (EUROPE)
	5300/75S
	5300/75S PLUS
	5325/80S
	5325/80SQ
	5325S
	5350/100SQ
	5350/90C
	5350/90C (EUROPE)
	5350/90Q-PM
	5350/90S
	5350/90S-PM
	5350C
	5350S
	5400/100S-WB-Q



7 1 2 2 1 8 0 0 1 6 4 8